

Interior Public Spaces

Multnomah County Central Courthouse



COURTROOM PERSPECTIVE

Interior Public Spaces

- The public spaces for the Centralized Public Service Center, Jury assembly and courtrooms are oriented with views to the Willamette River.
- Kiosks in the Public Service Center and high volume courts will reduce time needed for judicial processes through the Courthouse.
- Court Care is conveniently located on the ground floor.
- Jury assembly to have new comfortable chairs and a business center.
- Courtrooms to be larger than almost all of the courtrooms in the current courthouse and include attorney-client conference rooms.
- 21st century standards for audio visual technology.



PUBLIC CORRIDOR

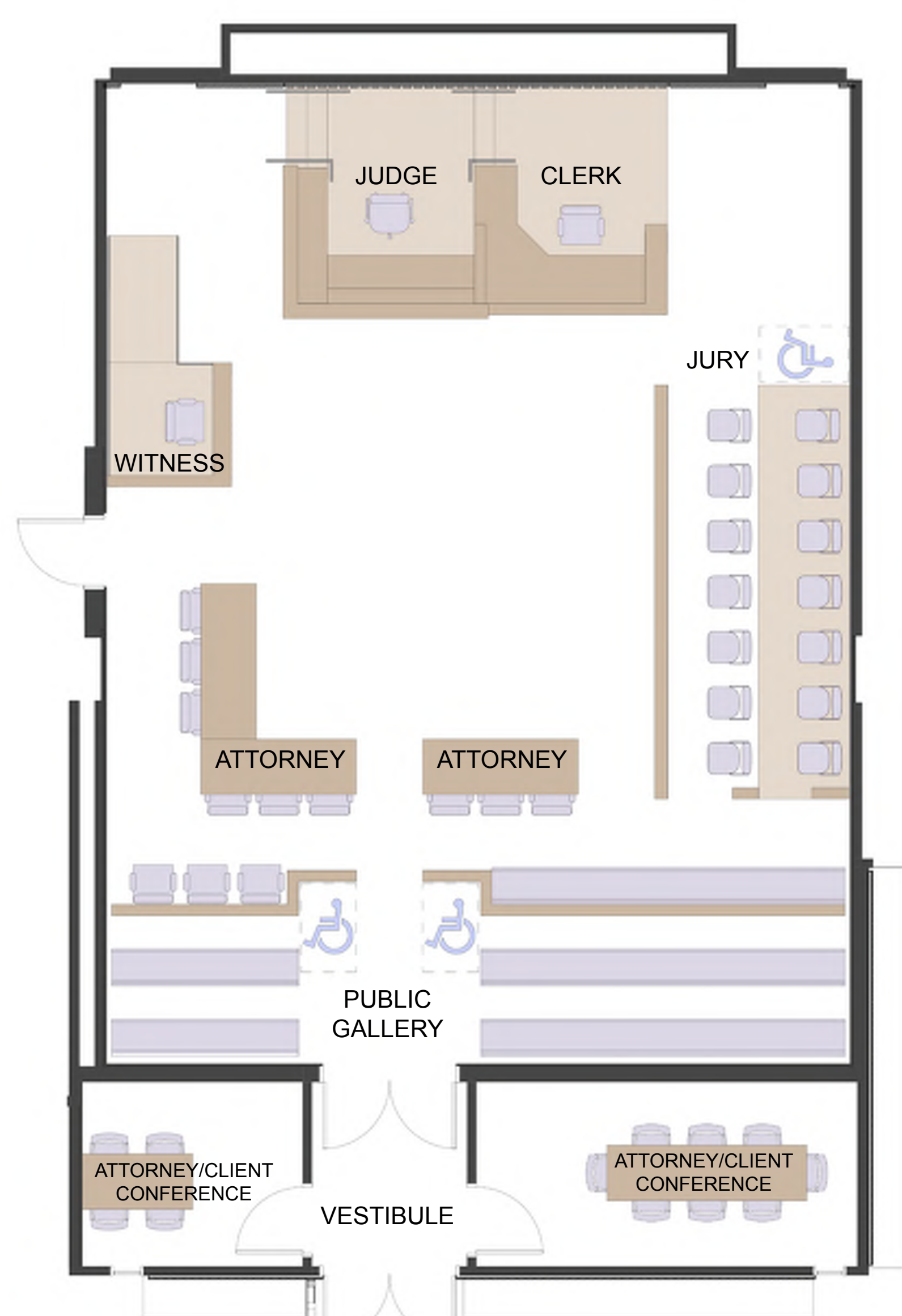

COURTROOM- LEVELS 7-17

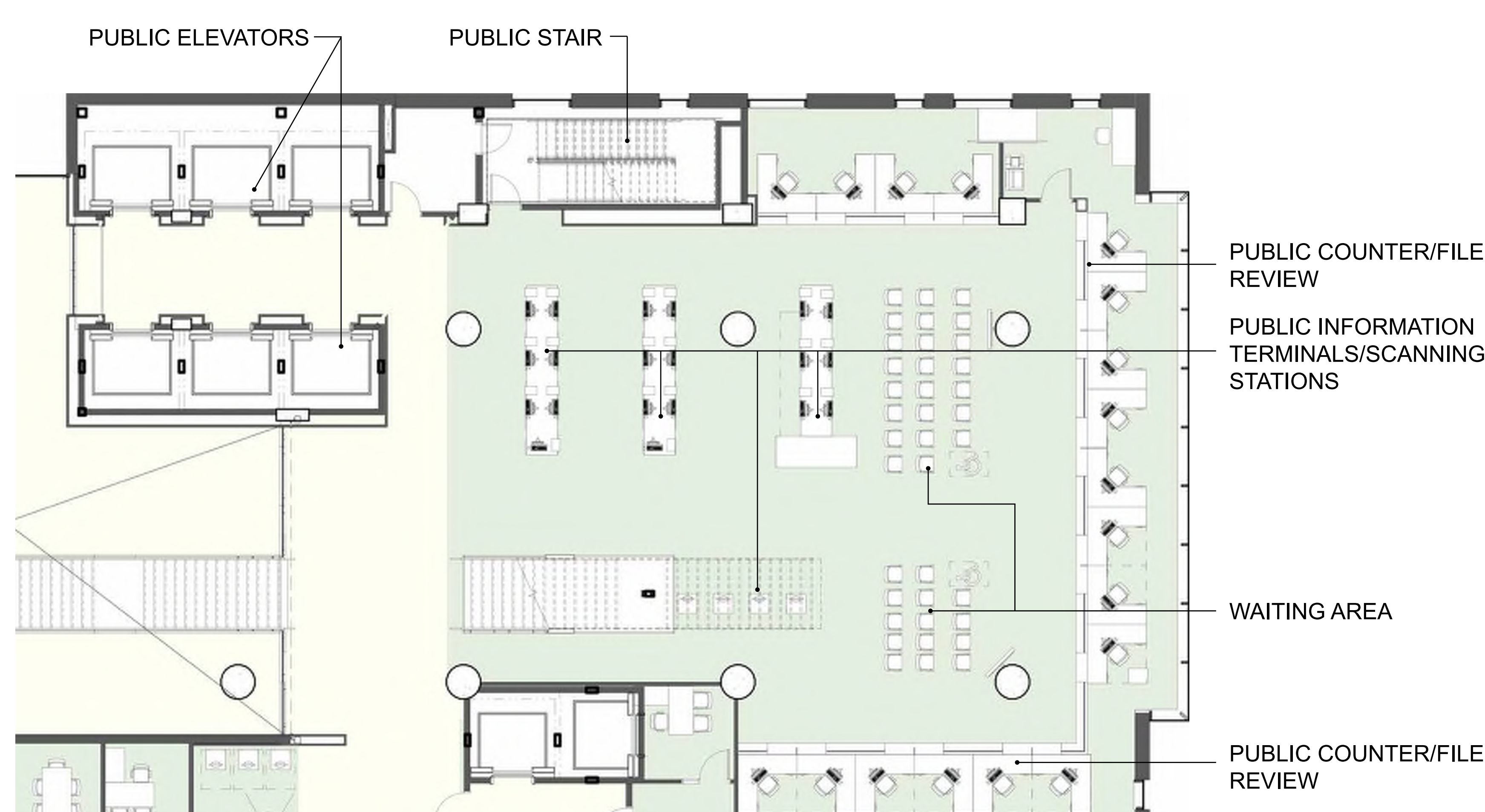

CENTRALIZED PUBLIC SERVICE CENTER- LEVEL 2

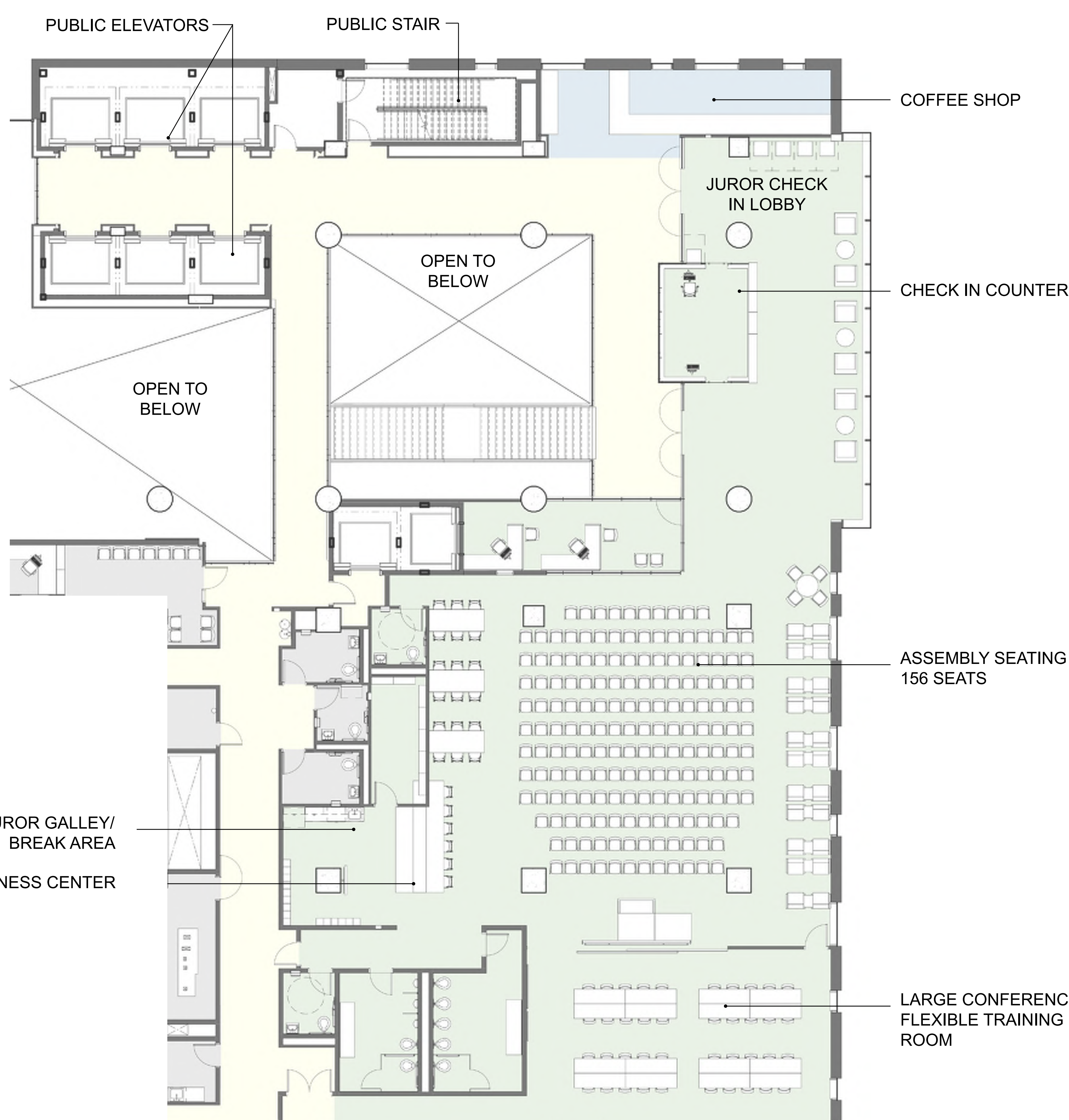

JURY ASSEMBLY- LEVEL 3



POTENTIAL VIEW FROM THE 12TH FLOOR PUBLIC AREA



POTENTIAL VIEW FROM NEW BUILDING

NOTE: ALL DESIGN INFORMATION IS IN DRAFT FORM AND SUBJECT TO CHANGE